

# Swivel castor with total lock CDT 200 TLSBAK

Transport Series CD - Wheel TLSBA

 -20 °C - +80 °C

- +++  
swivels easily
- +++  
wear resistant
- +++  
shock proof
- +++  
floor protective
- ++  
weather proof

## Wheel



Tread: cast polyurethane, 85 ± 2 Shore A crowned - soft

Core: Die-cast aluminium alloy

## Fork



Finish: electro-zinc plated, double ball bearing – revited, hardened steel balls thermoplastic dust protection ring, wheel axle bolted, total lock

Swivel castor with total lockWheel-Ø A x width B mm: 200x50	
Load Capacity kg:	300
Load capacity tested according to EN 12530 and EN 12527	
Overall height H mm:	240
Dimension of top plate TP	135x110
mm:	
Hole spacing HS mm:	105x80
Hole-Ø HD mm:	11
Swivel radius SR mm:	168
Wheel bearing:	Ball bearing

## Advantages

- ✓ crowned soft tread makes it very economic
- ✓ very silent in motion
- ✓ very low rolling resistance
- ✓ very revving
- ✓ high abrasion and tear resistance
- ✓ good chemical resistance

©Copyright 2024 Rollenbau GmbH, www.rollenbau.at 20.05.2024

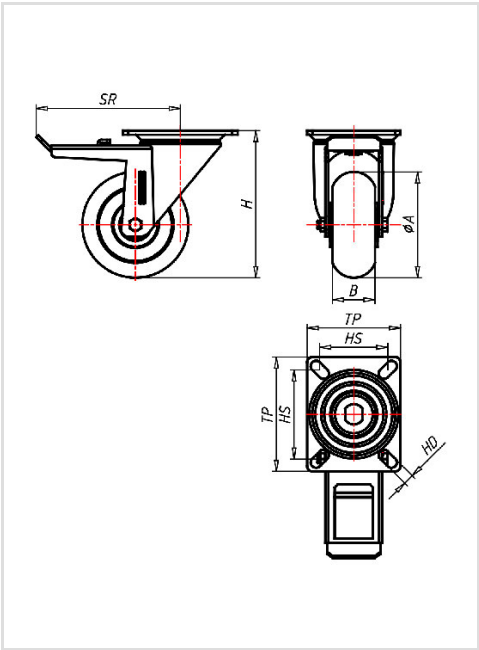

## Applications

- Metal-Technology
- Workshops
- Dollies
- Carpentry
- Building-Industry